

ORDINANCE NO. 10863

1  
2  
3  
4  
5  
6  
7  
8  
9  
10  
11  
12  
13  
14  
15  
16  
17  
18  
19  
20  
21  
22  
23  
24  
25  
26  
27  
28

AN ORDINANCE relating to the annexation of an area known as Lake Wilderness South to the Covington Water District.

STATEMENTS OF FACT:

1. A notice of intention proposing the annexation of an area known as Lake Wilderness South to Covington Water District was filed with the county council effective April 27, 1993.
2. Covington Water District has found the petition for annexation to be sufficient and has, by Resolution 1552 concurred with the proposed annexation.
3. Covington Water District filed a Declaration of Non-significant Impact dated March 22, 1993, on the proposed annexation.
4. The county council held a public hearing on the 2<sup>nd</sup> day of June, 1993 and has considered the criteria set forth in R.C.W. 57.02.040.

BE IT ORDAINED BY THE COUNCIL OF KING COUNTY:

SECTION 1. The annexation by Covington Water District of the area known as Lake Wilderness South and described in Section 4 is approved. This proposed annexation is consistent with R.C.W. 57.02.040 as described.

SECTION 2. Covington Water District is the appropriate entity to serve the area proposed to be annexed.

SECTION 3. Completion of this annexation does not constitute county approval or disapproval of any other permits, certifications, or actions necessary to provide water service to this annexation area.

1        SECTION 4. The area known as Lake Wilderness South to be  
2 annexed is described is as follows:

3 All that portion of the South Half of Government Lot 3  
4 Section 21, Township 22 North, Range 6 East W.M., lying  
5 Easterly of the West margin of Lake Wilderness Place  
6 Southeast

7 Except the North 100 feet of said South Half.

8 Also all that portion of Government Lot 7, Section 22  
9 North, Range 6 East, W.M., lying South of that 100 foot  
10 parcel known as Tract "A" Lake Wilderness Shore Acres  
11 (unrecorded).

12 Also the Northwest quarter of the Northwest quarter of  
13 Section 27, Township 22 North, Range 6 East W.M.

14 INTRODUCED AND READ for the first time this 24<sup>th</sup> day  
15 of May, 1993.

16 PASSED this 7<sup>th</sup> day of June, 1993.

17 KING COUNTY COUNCIL  
18 KING COUNTY, WASHINGTON

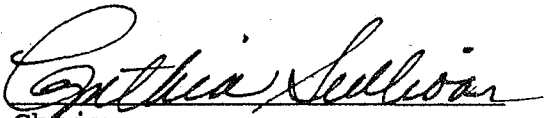
19   
20 VICE Chair

21 ATTEST:

22   
23 Clerk of the Council

24 APPROVED this 18<sup>th</sup> day of June, 1993.

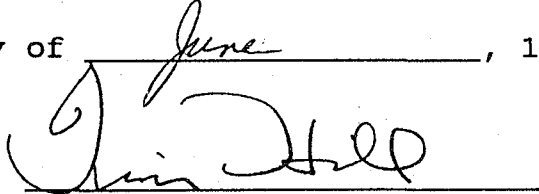
25   
26 King County Executive

NORTH  
↑

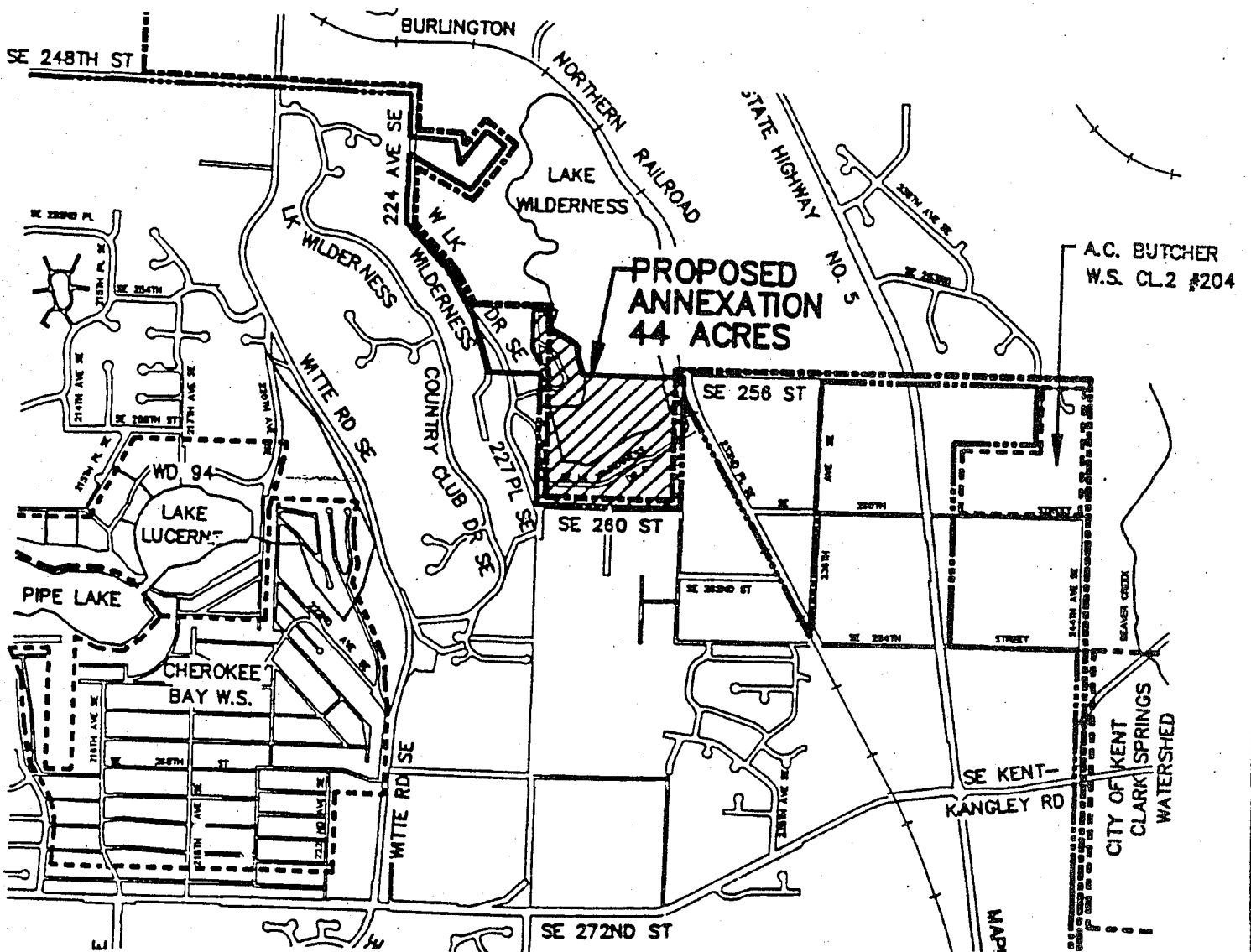
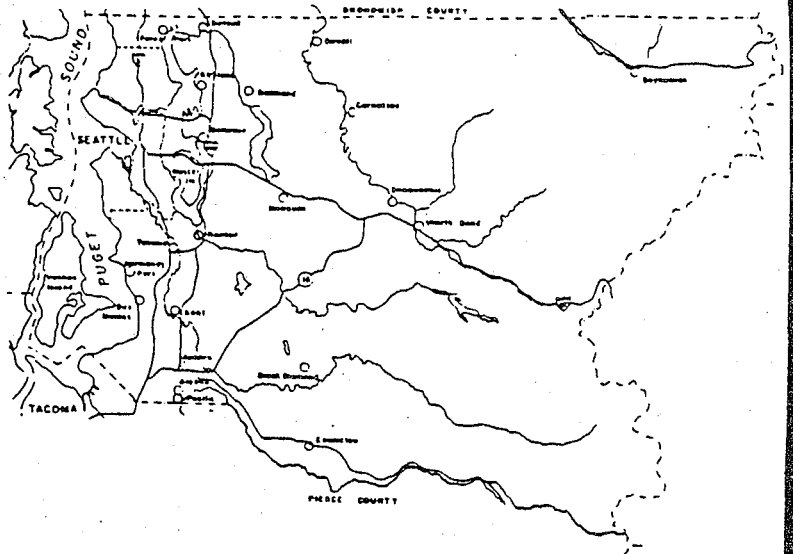

ANNEXATION TO Covington Water District - Lake Wilderness  
COUNCIL DISTRICT South - Annexation  
KING COUNTY ORD. NO. \_\_\_\_\_